



CLITHEROE & DISTRICT MOTOR CLUB

www.clitheroedmc.co.uk

DISHFORTH TARGA RALLY

14th February 2026

ROADBOOK



motorsport
diagrams





Dishforth Targa Rally

14th February 2026

TEST 1 & 4

Stop Astride test finish line then pull forward to the marshal for your time to be recorded.

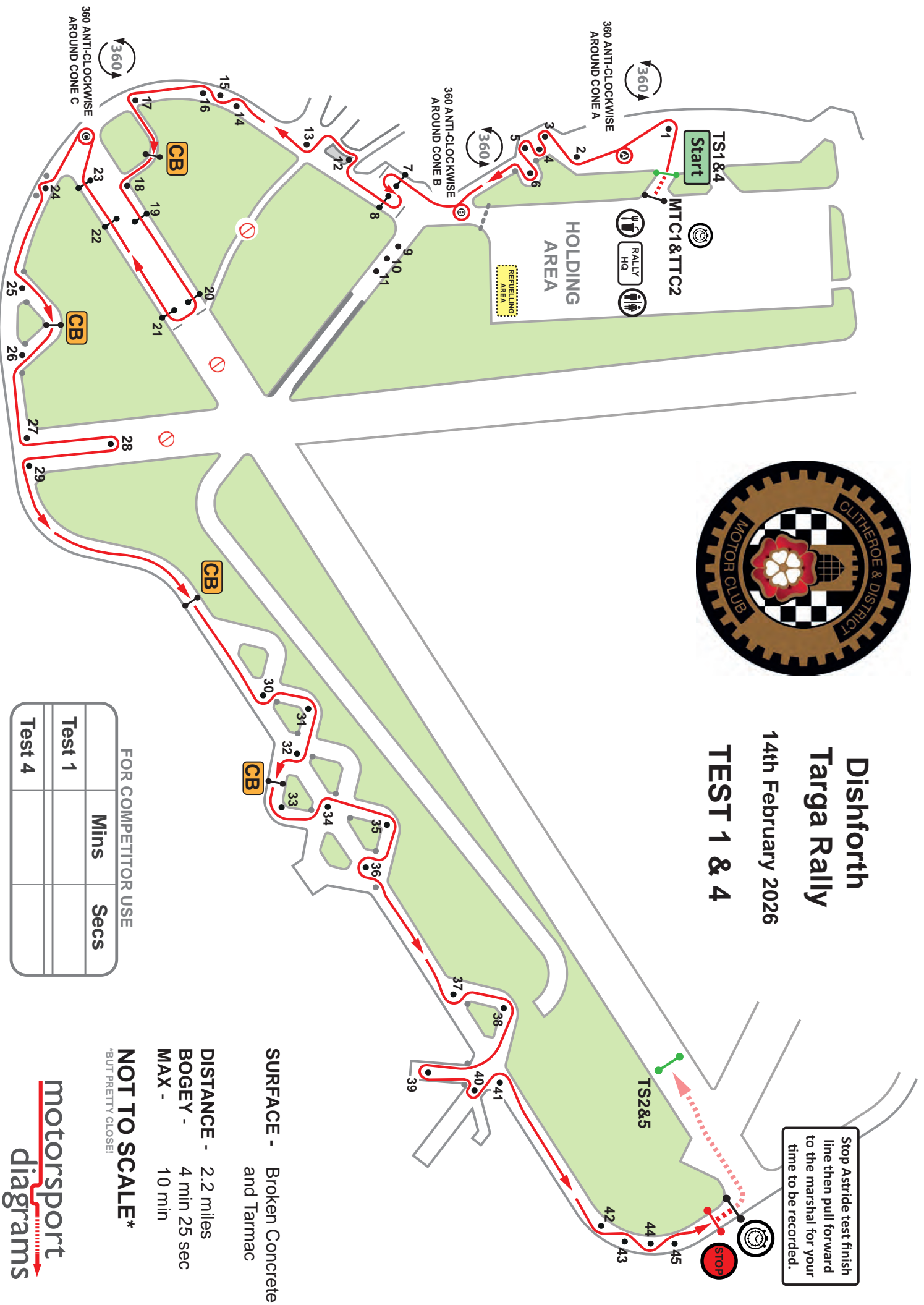

FOR COMPETITOR USE

	Mins	Secs
Test 1		
Test 4		

SURFACE - Broken Concrete and Tarmac

DISTANCE - 2.2 miles
BOGEY - 4 min 25 sec
MAX - 10 min

NOT TO SCALE*
*BUT PRETTY CLOSE!



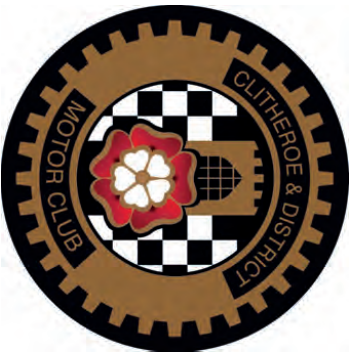

Dishforth Targa Rally

14th February 2026

TEST 2 & 5

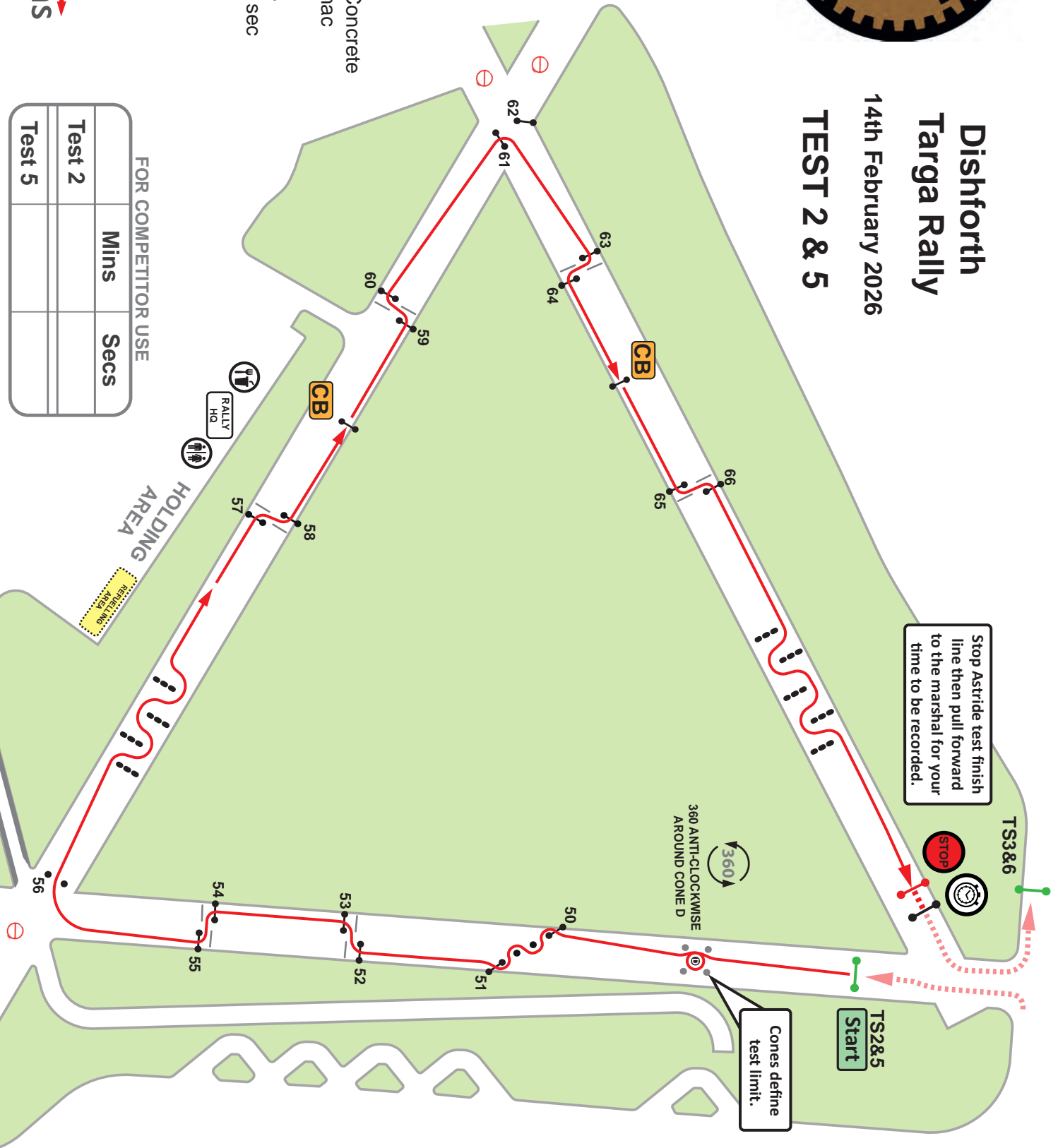

SURFACE - Broken Concrete and Tarmac

DISTANCE - 1.7 miles

BOGEY - 3 min 24 sec

MAX - 7 min

NOT TO SCALE*

*BUT PRETTY CLOSE!

FOR COMPETITOR USE

	Mins	Secs
Test 2		
Test 5		

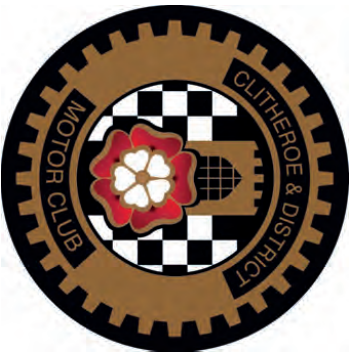

Dishforth Targa Rally

14th February 2026

TEST 3 & 6

SURFACE - Broken Concrete
and Tarmac

DISTANCE - 2.1 miles
BOGEY - 4 min 12 sec
MAX - 9 min

NOT TO SCALE*
*BUT PRETTY CLOSE!

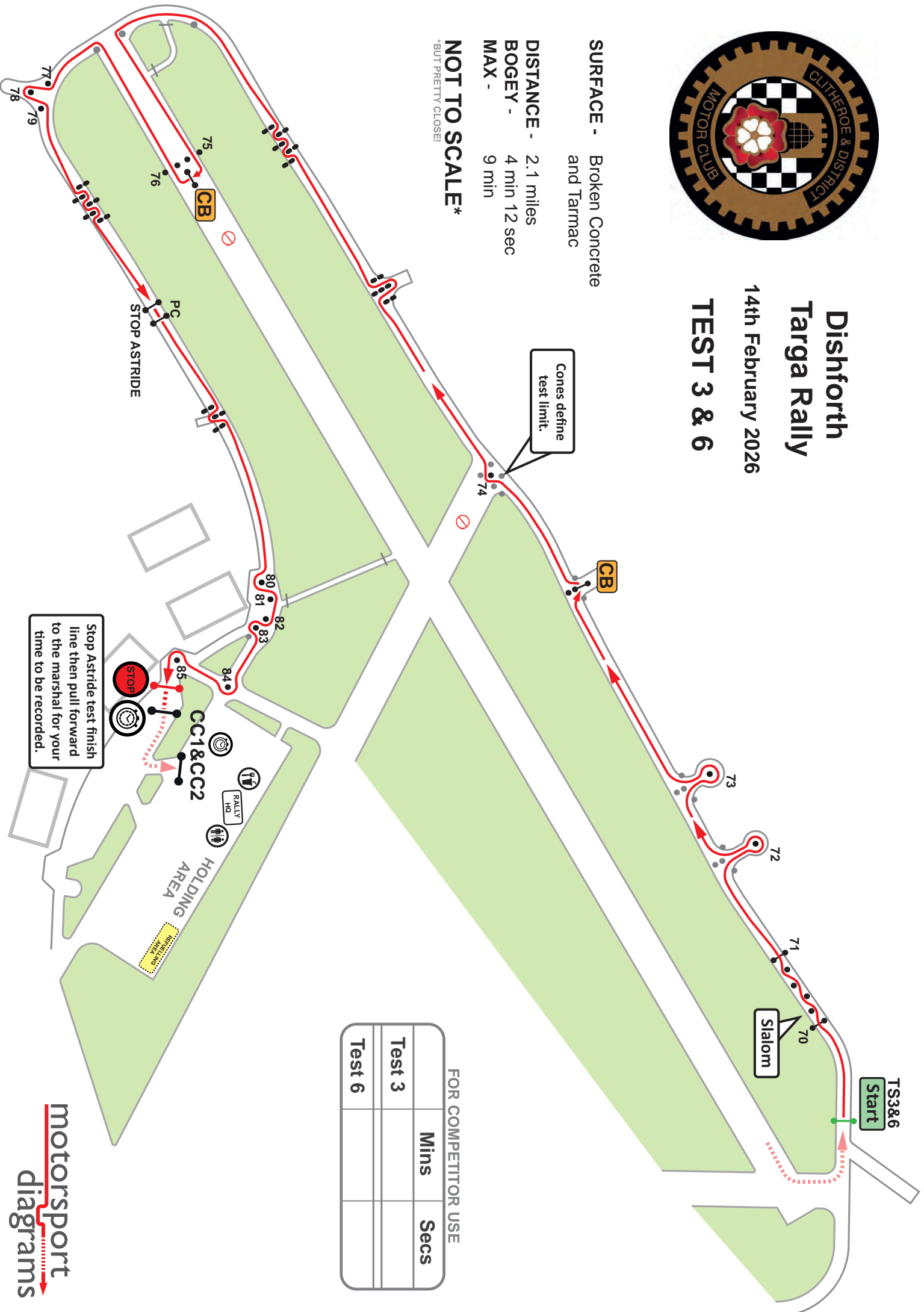

Stop Astride test finish
line then pull forward
to the marshal for your
time to be recorded.

FOR COMPETITOR USE

	Mins	Secs
Test 3		
Test 6		



Dishforth Targa Rally

14th February 2026

TEST 7 & 9

Stop Astride test finish line then pull forward to the marshal for your time to be recorded.

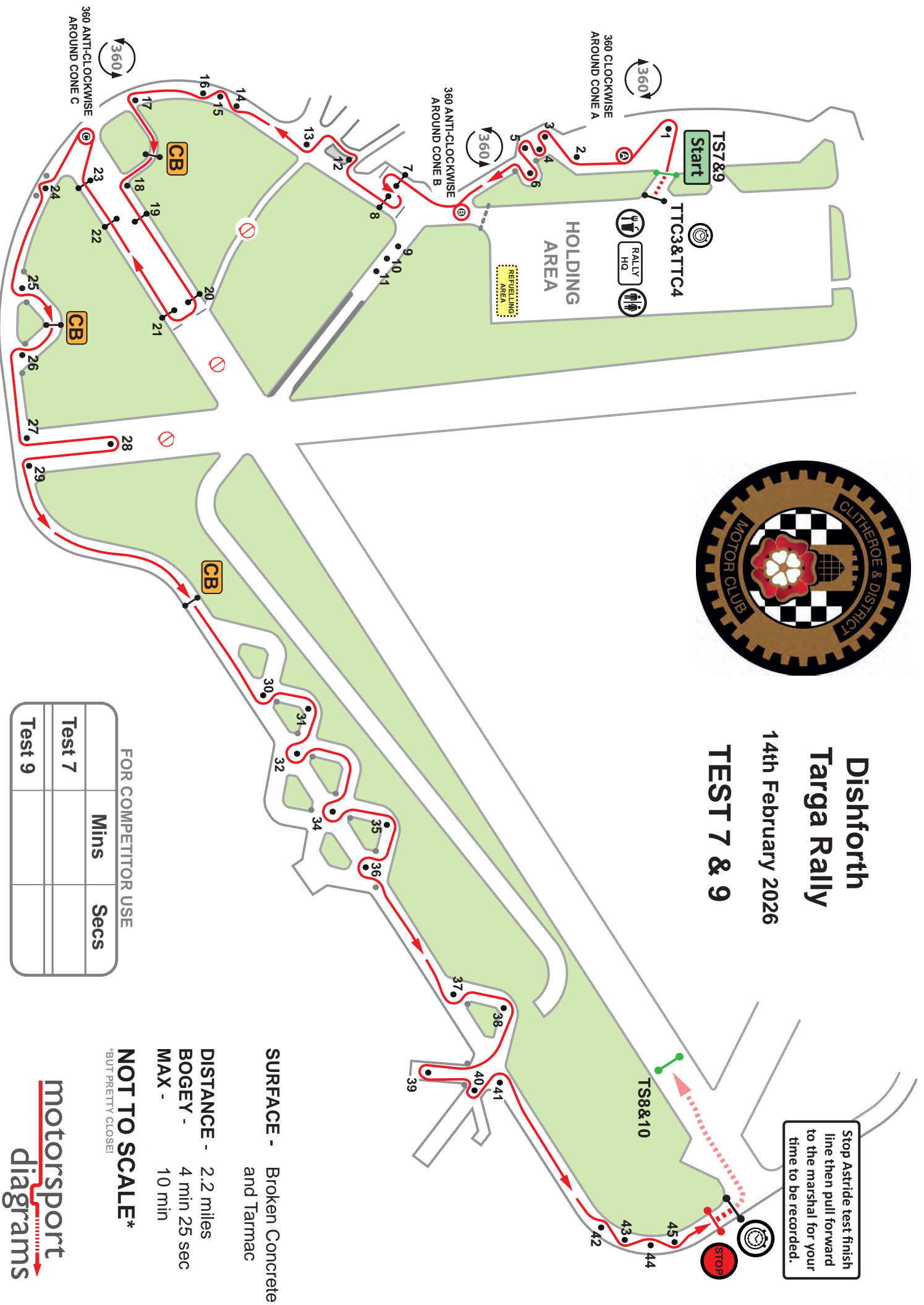

FOR COMPETITOR USE

	Mins	Secs
Test 7		
Test 9		

SURFACE - Broken Concrete and Tarmac

DISTANCE - 2.2 miles
BOGEY - 4 min 25 sec
MAX - 10 min

NOT TO SCALE*
*BUT PRETTY CLOSE!

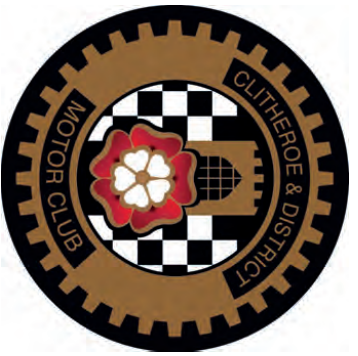

Dishforth Targa Rally

14th February 2026

TEST 8 & 10

FOR COMPETITOR USE

	Mins	Secs
Test 8		
Test 10		

SURFACE - Broken Concrete
and Tarmac

DISTANCE - 2.7 miles
BOGEY - 5 min 24 sec
MAX - 11 min

NOT TO SCALE*
*BUT PRETTY CLOSE!

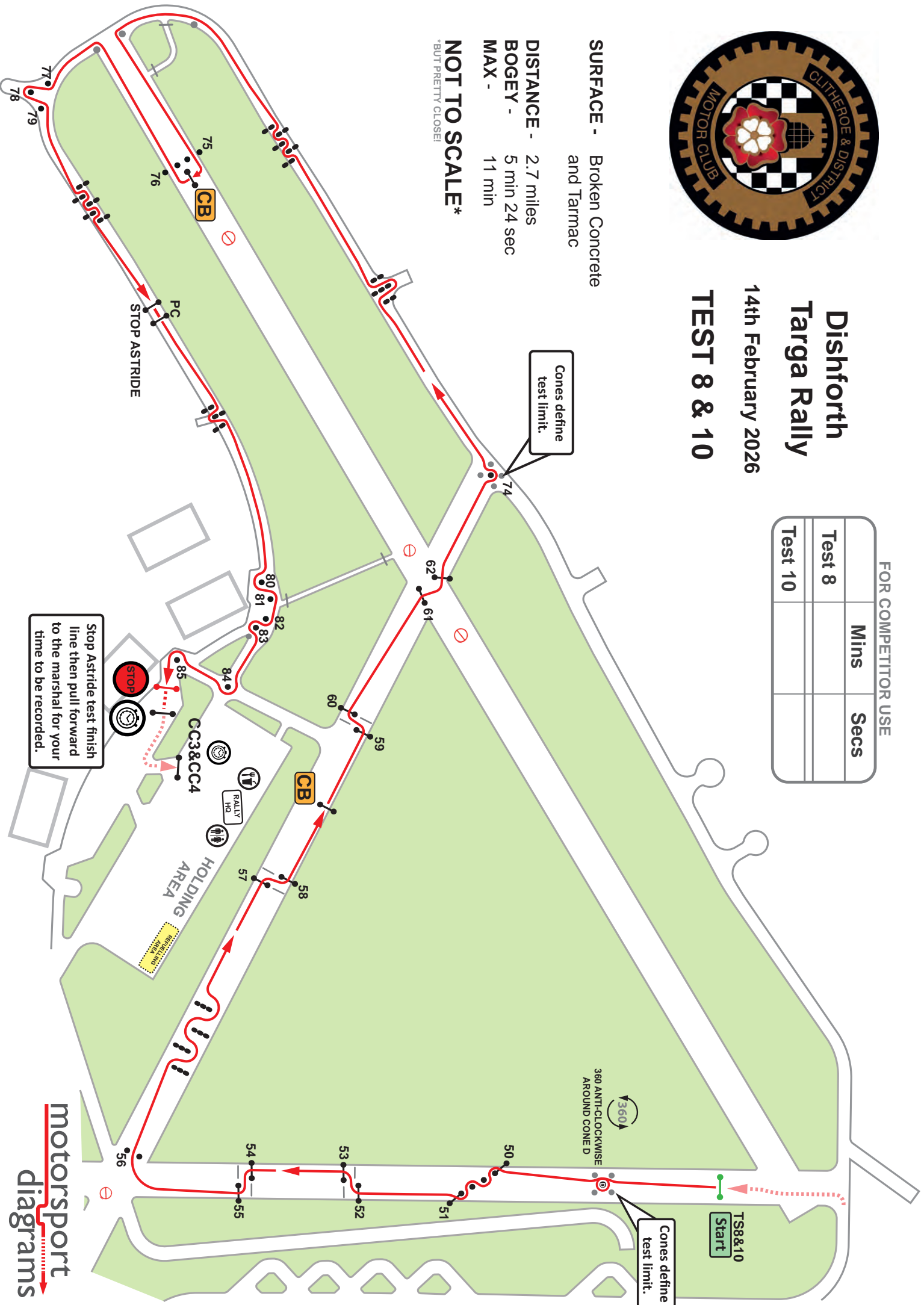

Cones define
test limit.

Cones define
test limit.

Stop Astride test finish
line then pull forward
to the marshal for your
time to be recorded.



Dishforth Targa Rally

14th February 2026

TEST 13, 14 & 15

SURFACE - Broken Concrete
and Tarmac

DISTANCE - 4.3 miles
BOGEY - 8 min 36 sec
MAX - 17 min

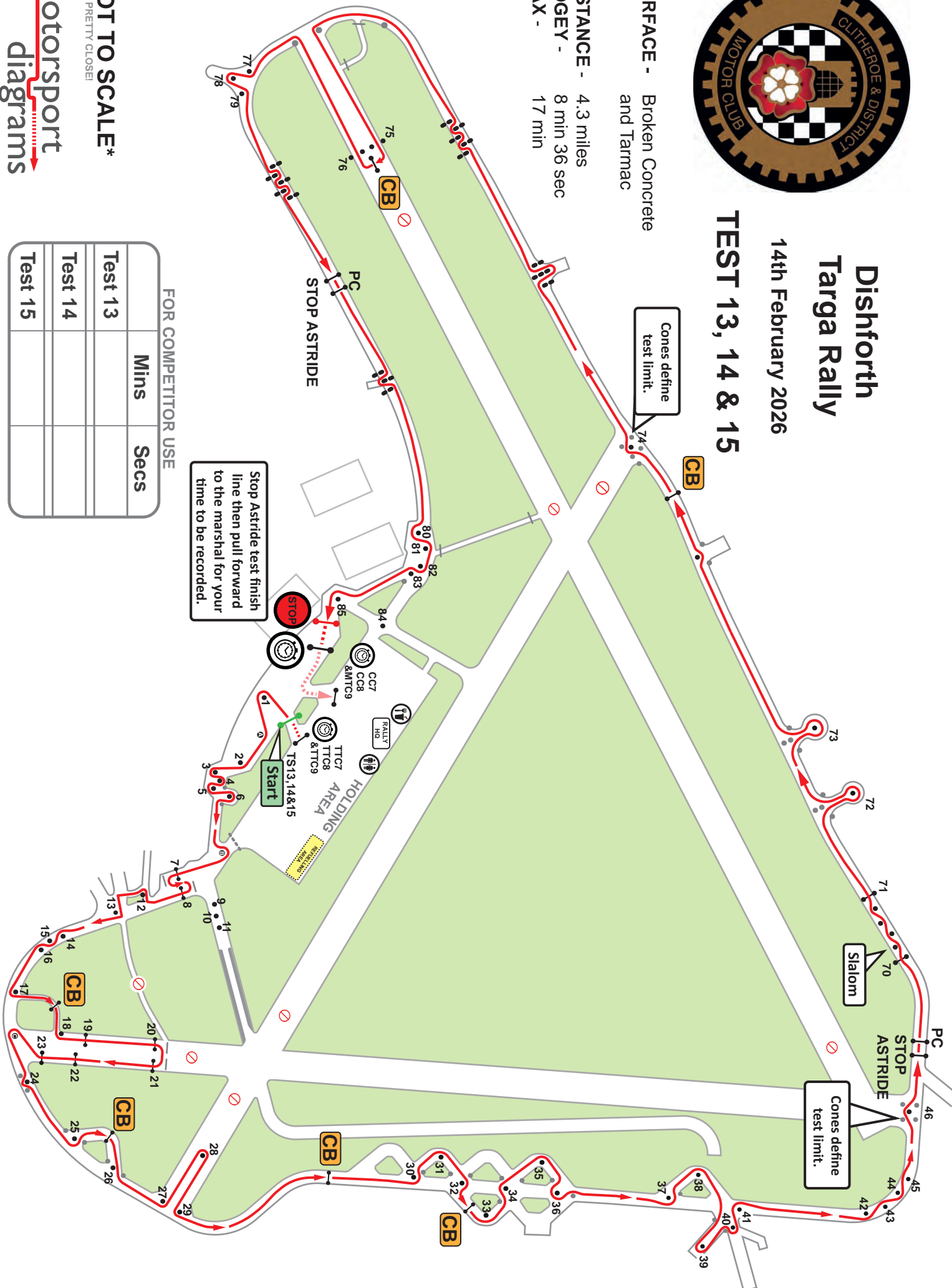

Stop Astride test finish line then pull forward to the marshal for your time to be recorded.

Cone define test limit.

Cone define test limit.

FOR COMPETITOR USE

	Mins	Secs
Test 13		
Test 14		
Test 15		

NOT TO SCALE*
*BUT PRETTY CLOSE!